

GOTHENBURG/OSTRA HOSPITAL ESHB	AERODROME ELEVATION 240 ft	ARP (WGS 84) 57° 43' 10.4" N 012° 03' 02.3" E
Status of certification	Dimensions	
Certified Heliport (2031-12-31)	Dimension FATO: Ø 20 m	
Location	Dimension TLOF: Ø 20 m	
At the south part of the hospital area	Dimensioned for HKP max rotor: Ø 16,3 m	
Elevated, located on the 7:th floor, building DSBUS	Max D value: 20 m	
Installations and visual aids	Safety Area: 40 m x 40 m ambient air	
Lights: TLOF edge, perimeter lights green Floodlight, flight path alignment guidance lights	FATO MTOW / MLW: 11 tonne	
Illuminated windsock, heliport beacon	Airport information	
Markings: Hospital heliport identification marking, touchdown/positioning marking, heliport name marking, maximum allowable mass marking, TLOF perimeter marking and flight path alignment guidance marking	Ambulance and Resque flights only	
Surface: Concrete (heated)	PPR 15 min (H24) PN to HEMS-coordinator: +46 (0)31-334 11 96	
Fuel: Not available	If available PN to Heliport officer on RAKEL channel: 350 Hkp-SU/Östra	
RFF: RFF services available, Cat H2, accessible equipment in heliport control area.	Heliport is open when lights are ON	
	Heliport service: 031-342 65 00 alt. RAKEL 3 51-3009	
	County council: 031-342 10 00	
	https://fastighet.vgregion.se/heliport helikopterflygplatser@vgregion.se	

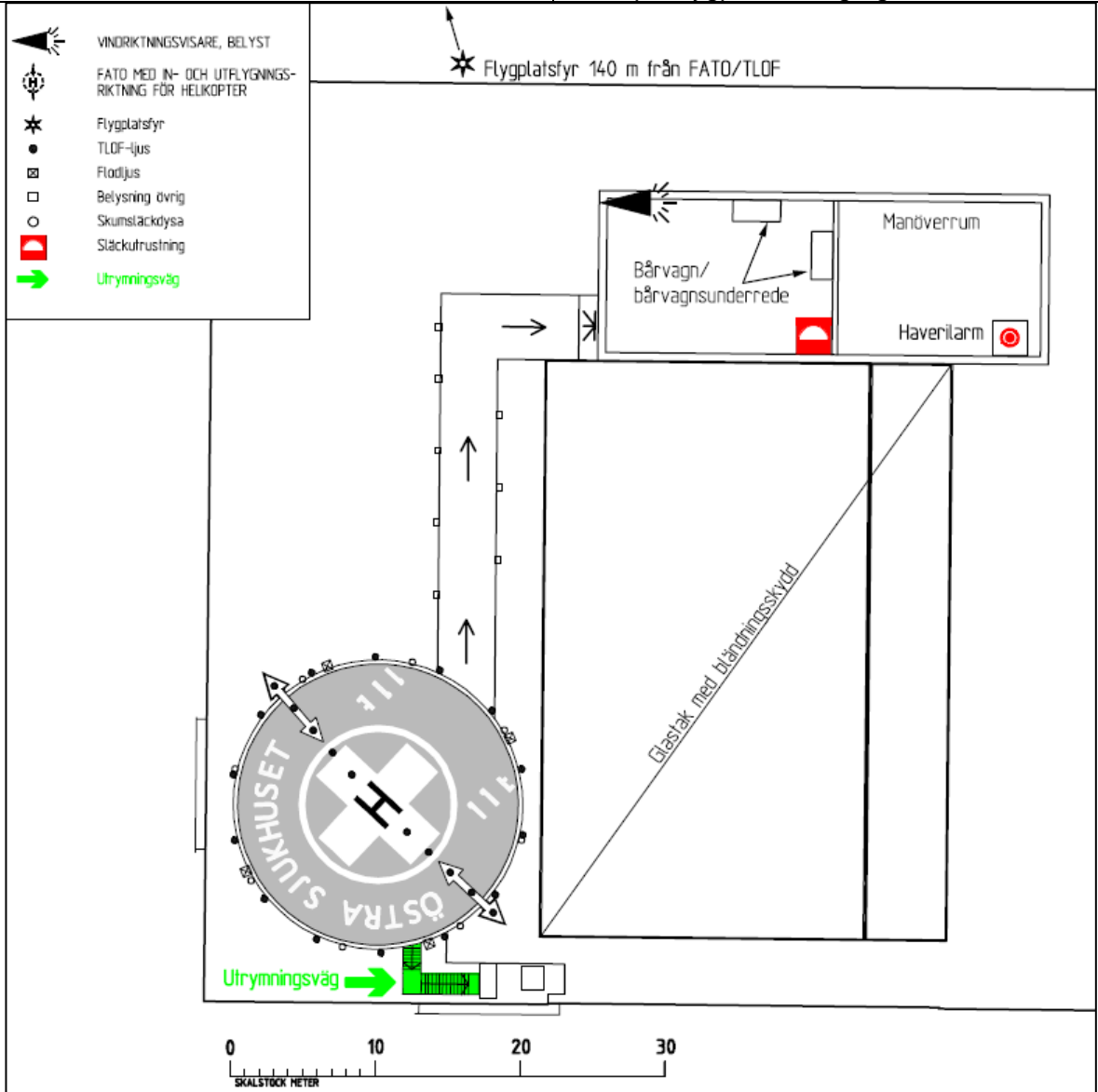

**GOTHENBURG/OSTRA HOSPITAL
ESHB**

AERODROME ELEVATION
240 ft

ARP (WGS 84)
57° 43' 10.4" N
012° 03' 02.3" E

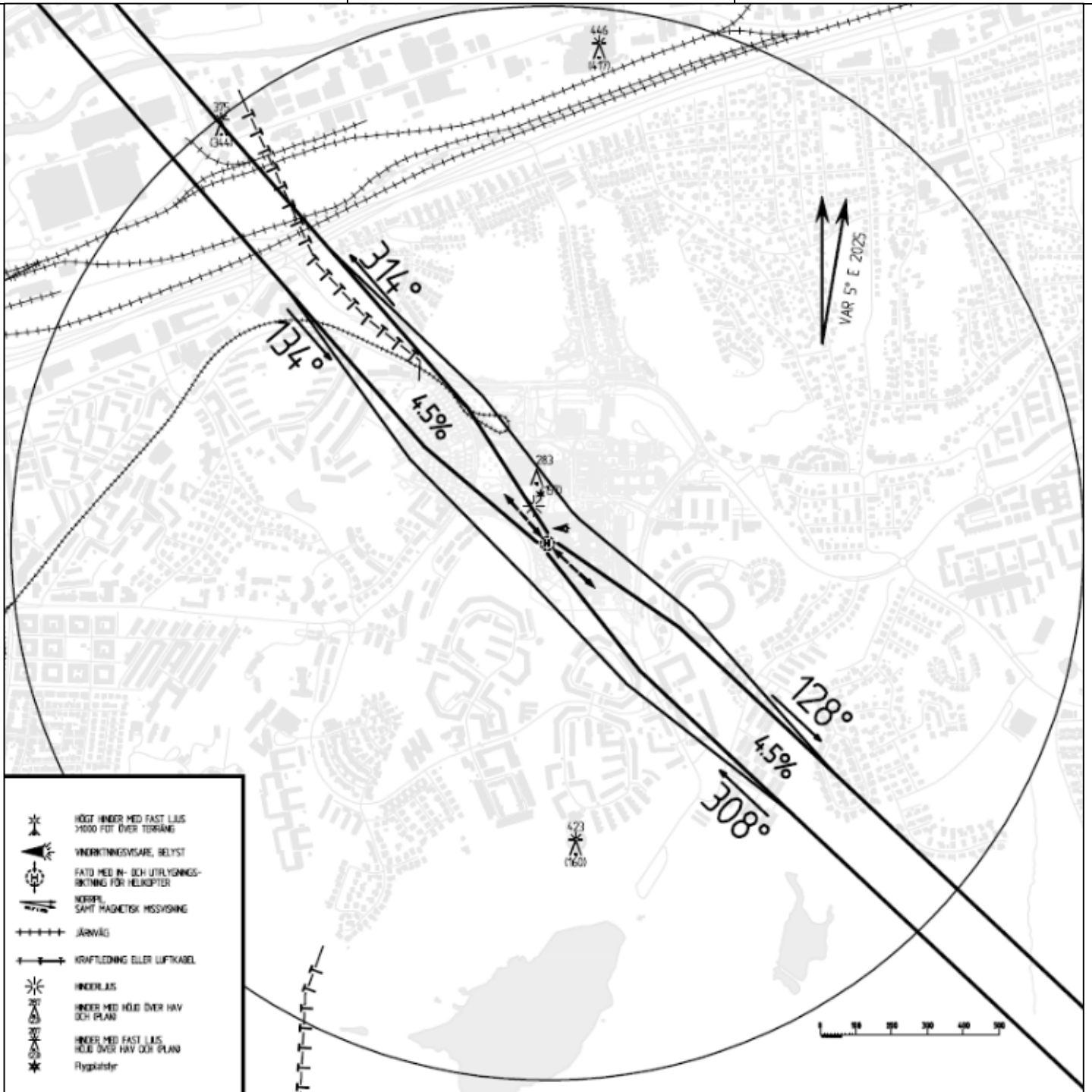

Obstacle free surfaces and approach & landing directions

Sector Northwest

Approach Surface from NW:
138,88° GEO / 134° MAG
4,5 %

Start and Climb Surface to NW:
318,91° GEO / 314° MAG
4,5 %

Sector Southeast

Approach Surface from SO:
313,27° GEO / 308° MAG
4,5 %

Start and Climb Surface to SO:
133,23° GEO / 128° MAG
4,5 %

See also heliport chart, obstacle charts, NOTAM and AIP SUP for obstacles in sectors.

NOISE ABATEMENT PROCEDURES

No noise abatement procedures established.

SURROUNDING AIRPORTS AND AIRSPACE

Below Göteborg TMA b 1500 AMSL
Göteborg APP 124.680 MHz/124.205 MHz

Below Göteborg TMA a 4500 AMSL
Göteborg APP 124.680 MHz/124.205 MHz

Säve airfield 6.5 NM NW,
Säve Radio 123.350 MHz

CHANGE: Säve CTR withdrawn and new radio frequency, new website address.

16 JAN 2026

BL