

GOTHENBURG / SAHLGRENSKA UNIVERSITY HOSPITAL ESHS	AERODROME ELEVATION 180 FOT	ARP (WGS 84) 57° 41' 0.9" N 011° 57' 23.8" E
Status of certification	Dimensions	
Certified Heliport (2034-02-28)	Dimension FATO: Ø 28 m	
Location	Dimension TLOF: Ø 28 m	
At the northwest part of the hospital area	Dimensioned for HKP max rotor: Ø 16,4 m	
Elevated, floor 5, on top of a car park	Max D value: 20 m	
Installations and visual aids	Safety Area: 40 m x 40 m steel and air	
Lights: TLOF edge, perimeter lights green Floodlights	FATO MTOW / MLW: 11 ton	
Illuminated windsock, heliport beacon	Airport information	
Markings: Hospital heliport identification marking, heliport name marking, TLOF perimeter marking and flight path alignment guidance marking	Ambulance and Resque flights only	
Surface: Steel (not heated)	PPR 15 min (H24) PN to HEMS-coordinator: +46 (0)31-334 11 96	
Fuel: Not available	PN to Heliport officer on RAKEL channel: 350 Hkp-SU	
RFF: RFF services available, Cat H2, accessible equipment in heliport control office.	Heliport is open when lights are ON	
	Heliport service: 031-342 65 00 alt. RAKEL 3 51-3009 County council: 031-342 10 00	
	https://fastighet.vgregion.se/heliport helikopterflygplatser@vgregion.se	

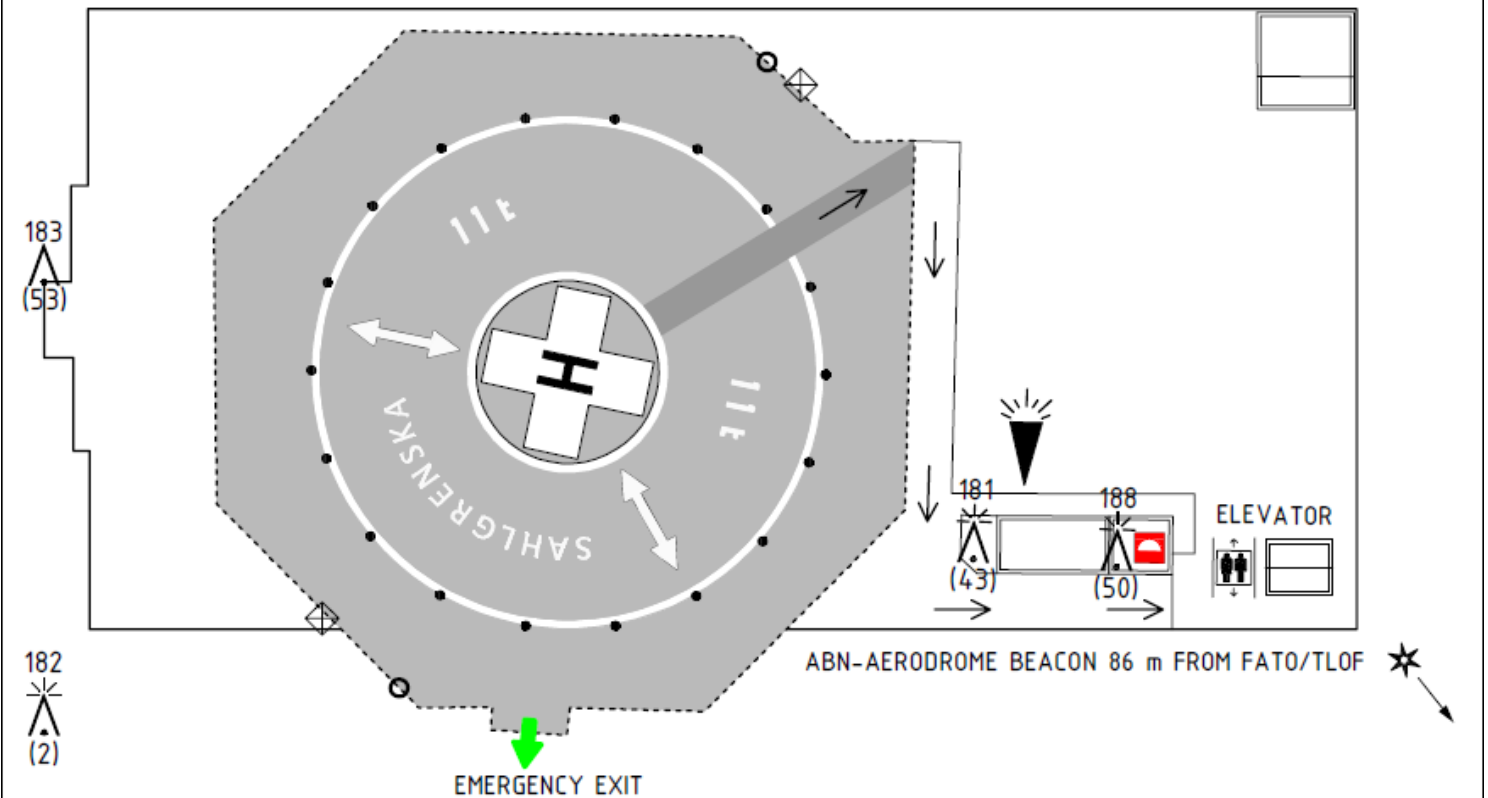
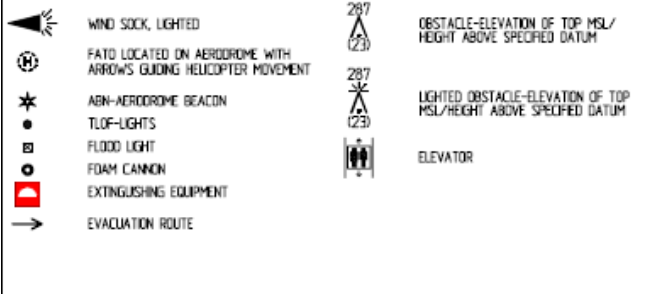

CHANGE: Säve CTR withdrawn and new radio frequency, changed website address.

16 JAN 2026

BL

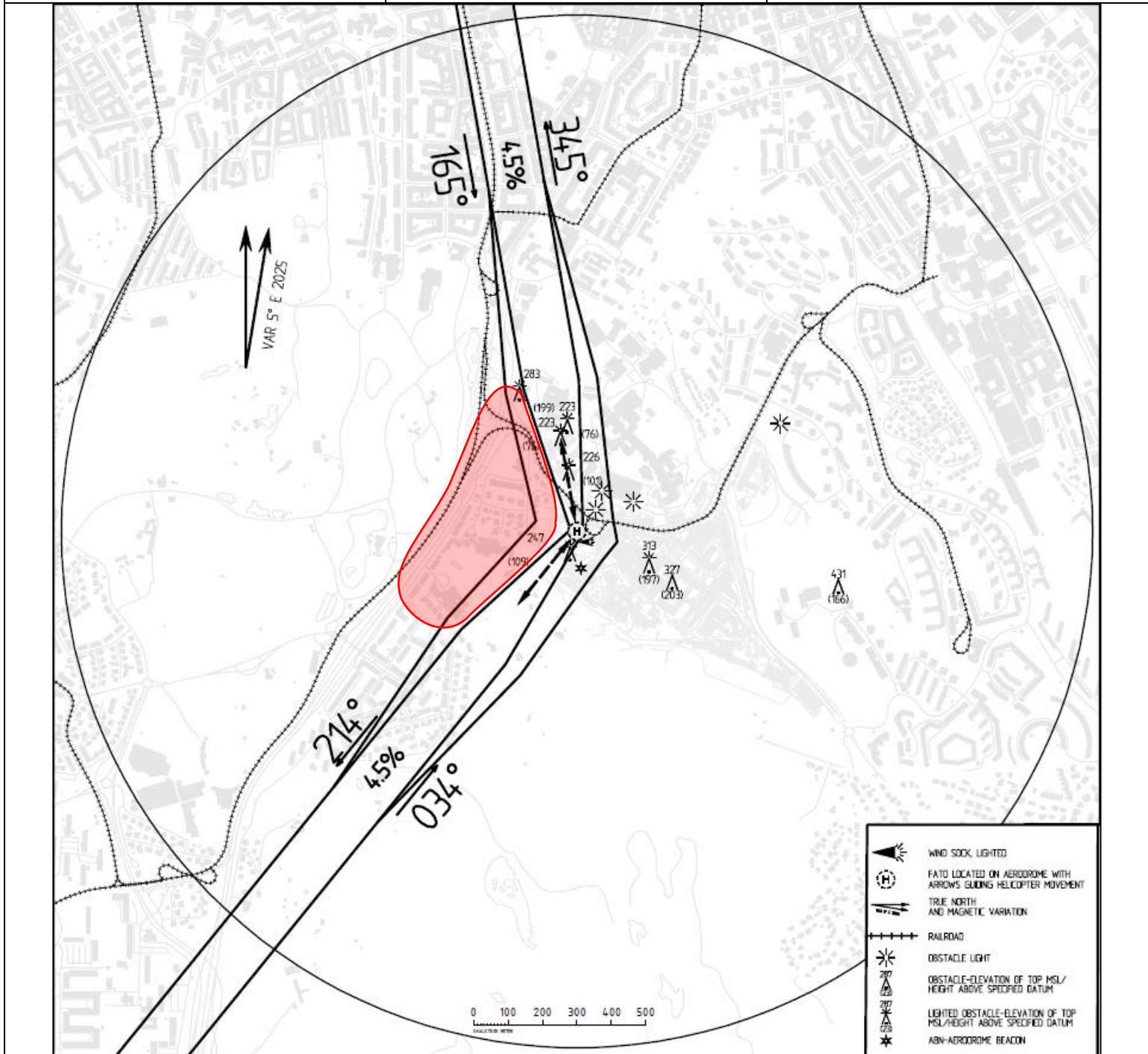

Obstacle free surfaces and approach & landing directions

<p>Sector North Approach Surface from N: 169,99° GEO / 165° MAG 4,5 %</p> <p>Start and Climb Surface to N: 350,00° GEO / 346° MAG 4,5 %</p>	<p>Sector Southwest Approach Surface from SW: 038,97° GEO / 034° MAG 4,5 %</p> <p>Start and Climb Surface to SW: 219,00° GEO / 215° MAG 4,5 %</p>
--	--

See also heliport chart, obstacle charts, NOTAM and AIP SUP for obstacles in sectors.

NOISE ABATEMENT PROCEDURES

Avoid overflying area west of the heliport, see heliport chart.

SURROUNDING AIRPORTS AND AIRSPACE

Below Göteborg TMA b 1500 AMSL
Göteborg APP 124.680 MHz/124.205 MHz

Below Göteborg TMA a 2500 AMSL
Göteborg APP 124.680 MHz/124.205 MHz

Säve airfield 6.0 NM NW,
Säve Radio 123.350 MHz

ESTABLISHED PINS RNP PROCEDURES (PinS RNP APCH and PinS RNP DEP)

CHANGE: Säve CTR withdrawn and new radio frequency, changed website address.

16 JAN 2026

BL